

PIER

2 BEDROOM APARTMENT

| | | |
|----------------------------------|-------------------|------------------|
| KITCHEN/LIVING/DINING | 7.18m x 3.81m | 23'7" x 12'6" |
| MASTER BEDROOM | 5.04m x 2.60m | 16'6" x 8'6" |
| BEDROOM 2 | 4.44m x 2.61m | 14'7" x 8'7" |
| GROSS INTERNAL FLOOR AREA | 66.24 sq m | 713 sq ft |

APARTMENTS:

101/106/108/109/112/205/206/209/212/213/301/
305/308/312/313/401/405/406/408/409/413/501/
505/506/509/512/513/606/608/609/612/701/712/
713/801/813

LOCATION

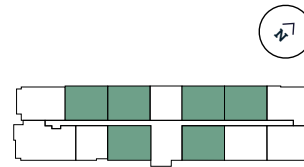

FLOORS

- 8th Floor
- 7th Floor
- 6th Floor
- 5th Floor
- 4th Floor
- 3rd Floor
- 2nd Floor
- 1st Floor

Note: 4th floor shown for reference. Please speak to the Sales Agent for apartment locations on other floors.



Disclaimer: The information featured does not form part of any contract, and while reasonable effort has been made to ensure accuracy, this cannot be guaranteed and no representation or warranty is made in that regard. Please note that these details are intended to give general indication of the apartment types available and should be used as a guide only. Apartment type prices vary depending on location within the overall development. Please consult with your Sales Agent for further information.